



DOWNING COLLEGE  
UNIVERSITY OF CAMBRIDGE

# THE BUTTERFIELD BUILDING

(Fig. 1)

## Butterfield Room

The Butterfield Room can be hired in conjunction with the Bar & Café (on the ground floor) for parties and special events.

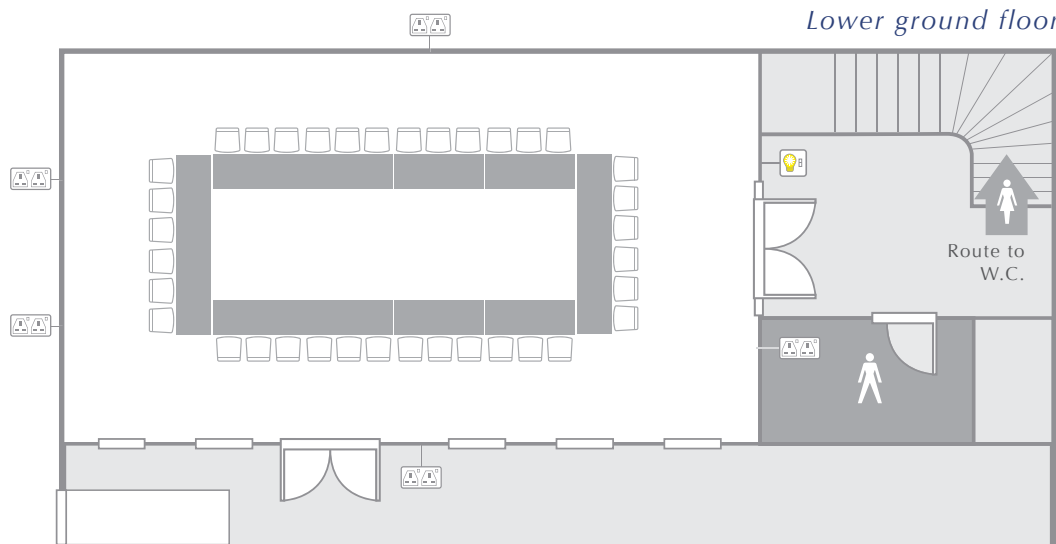

### DIMENSIONS

The Butterfield Room 13m x 7m **91m<sup>2</sup>**      The Butterfield Bar 13m x 7m **91m<sup>2</sup>**      Combined **182m<sup>2</sup>**

### CAPACITY

Boardroom (Fig. 1 above) **36**      Theatre Delegates **72**      Classroom **72**

EQUIPMENT Data projector, OHP, Pads and pens are available on request.

Situated below the Butterfield Bar via a stairwell, the Butterfield Room is the perfect accompanying recreational room for workshops, parties and evening relaxation events.

VIEW OF THE BUTTERFIELD ROOM SET UP IN CLASSROOM STYLE



CONFERENCE SERVICES

**01223 334 860**

[conference@dow.cam.ac.uk](mailto:conference@dow.cam.ac.uk)

PLEASE SEE OVERLEAF FOR A MAP SHOWING THE ROOM'S LOCATION IN THE COLLEGE AND ALTERNATIVE ROOM LAYOUTS

# THE BUTTERFIELD BUILDING

## DOWNING COLLEGE CAMBRIDGE

### FINDING THE BUTTERFIELD BUILDING

All visitors are kindly requested to report to the Porters' Lodge. This can be found on the left hand side as you walk through the main College gates on Regent Street.

### PARKING

Once inside the main gate, turn right, pass through the barrier and follow car park along to the 'Conference Parking Area'.

### FIRE ASSEMBLY POINT

In the unlikely event of a fire, please note the Fire Assembly Point for the Butterfield Building is in front of the Library and East Lodge Garden sundial.



### *Butterfield Room*

Lecture Theatre **72**

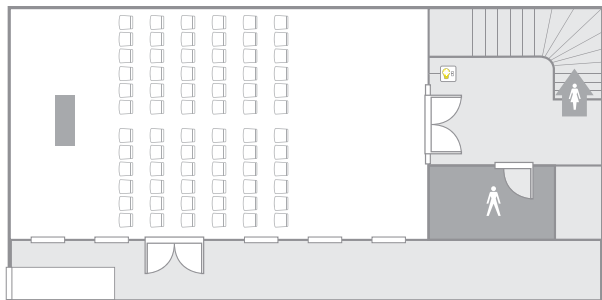

*Lower ground floor*

### *Butterfield Room*

Classroom **72**



*Lower ground floor*



*Ground floor*

To discuss further layouts please contact Conference Services

**01223 334 860**

[www.downing-conferences-cambridge.com](http://www.downing-conferences-cambridge.com) | [conference@dow.cam.ac.uk](mailto:conference@dow.cam.ac.uk)