



DOWNING COLLEGE
UNIVERSITY OF CAMBRIDGE

HOWARD THEATRE

(Fig. 1)

First Floor

Stairs and lift lead down to WCs in the basement.

STAGE DIMENSIONS

11m x 3.5m

38.5 m²

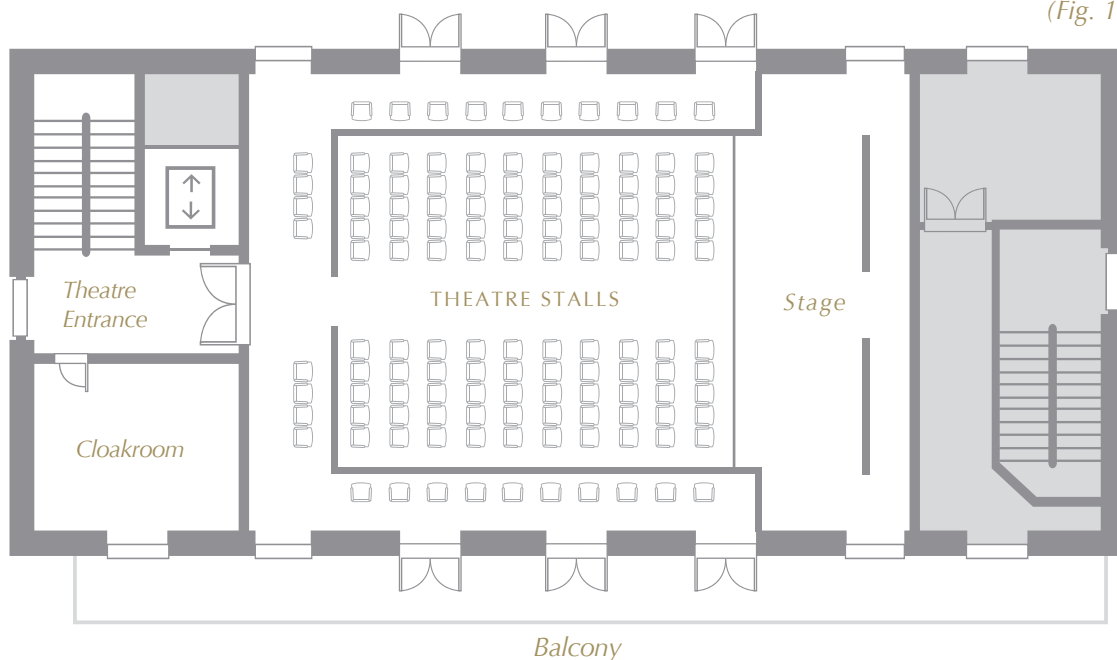

CAPACITY

Forward facing and tiered seating **120** Perimeter seating **20** Gallery seating (second floor) **20**

EQUIPMENT

See reverse of this page for a list of the equipment available for Conferences and Meetings in the Howard Theatre.

The Howard Theatre Stalls are located on the first floor and Theatre Gallery on the second floor. Fixed tiered and forward facing seating for 120 and 40 seats located around the Theatre perimeter and second floor gallery, offers a maximum capacity of 160.

The Theatre is ideal for conferences, training sessions, lectures, presentations, theatre productions, musical concerts, and many other events.



CONFERENCE SERVICES

01223 334 860

PLEASE SEE OVERLEAF FOR A MAP SHOWING THE ROOM'S LOCATION IN THE COLLEGE AND ALTERNATIVE ROOM LAYOUTS

conference@dow.cam.ac.uk

HOWARD THEATRE

DOWNING COLLEGE CAMBRIDGE

FINDING THE HOWARD THEATRE

All visitors are kindly requested to report to the Porters' Lodge. This can be found on the left hand side as you walk through the main College gates on Regent Street.

PARKING

Once inside the main gate, turn right, pass through the barrier and follow car park along to the 'Conference Parking Area'.

FIRE ASSEMBLY POINT

In the unlikely event of a fire, please note the Fire Assembly Point for the Howard Theatre is on the Sunken Garden of Howard Court.

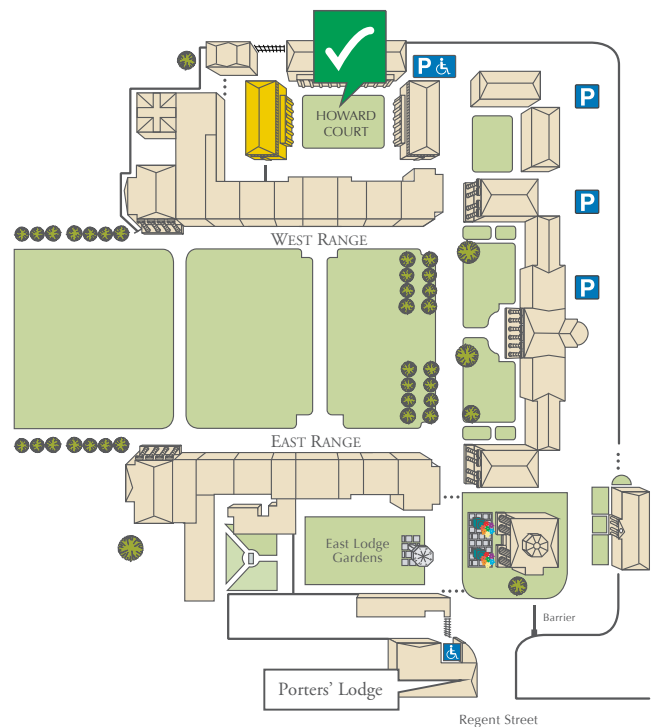

CONFERENCES & MEETINGS

Second Floor Gallery

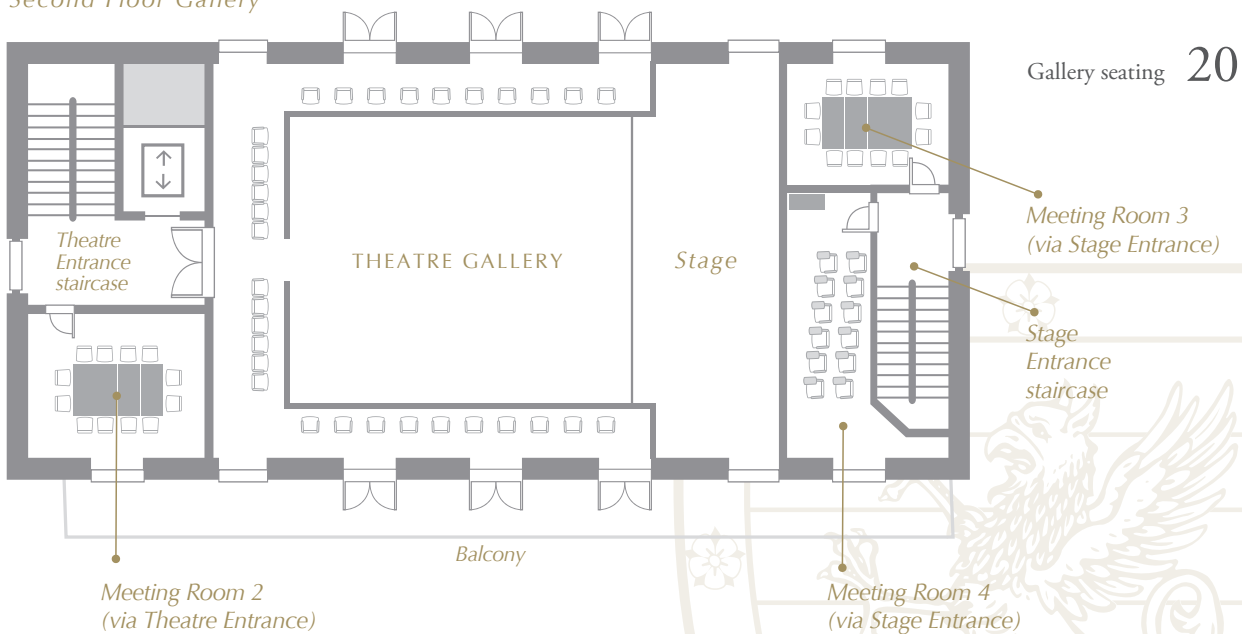

HOWARD THEATRE CONFERENCES AND MEETINGS EQUIPMENT

Wide screen Data projector for presentation (e.g. Microsoft Power Point, Windows, DVD and VHS Player)

PA system with a range of microphones : 4 radio lapel, 4 radio handheld, 2 lectern and 4 table), 10 Infrared headphones for assisted hearing or bi-lingual translation.

Audio Visual operation is controlled by an AMX system that offers an Interactive Lectern control for the projection screen, Black-out blinds, lighting and the audio-video system.

Ethernet internet connection.

WiFi is available using a Lapwing log-in code which can be supplied by the Conference Services Office.

01223 334 860

www.downing-conferences-cambridge.com | conference@dow.cam.ac.uk