

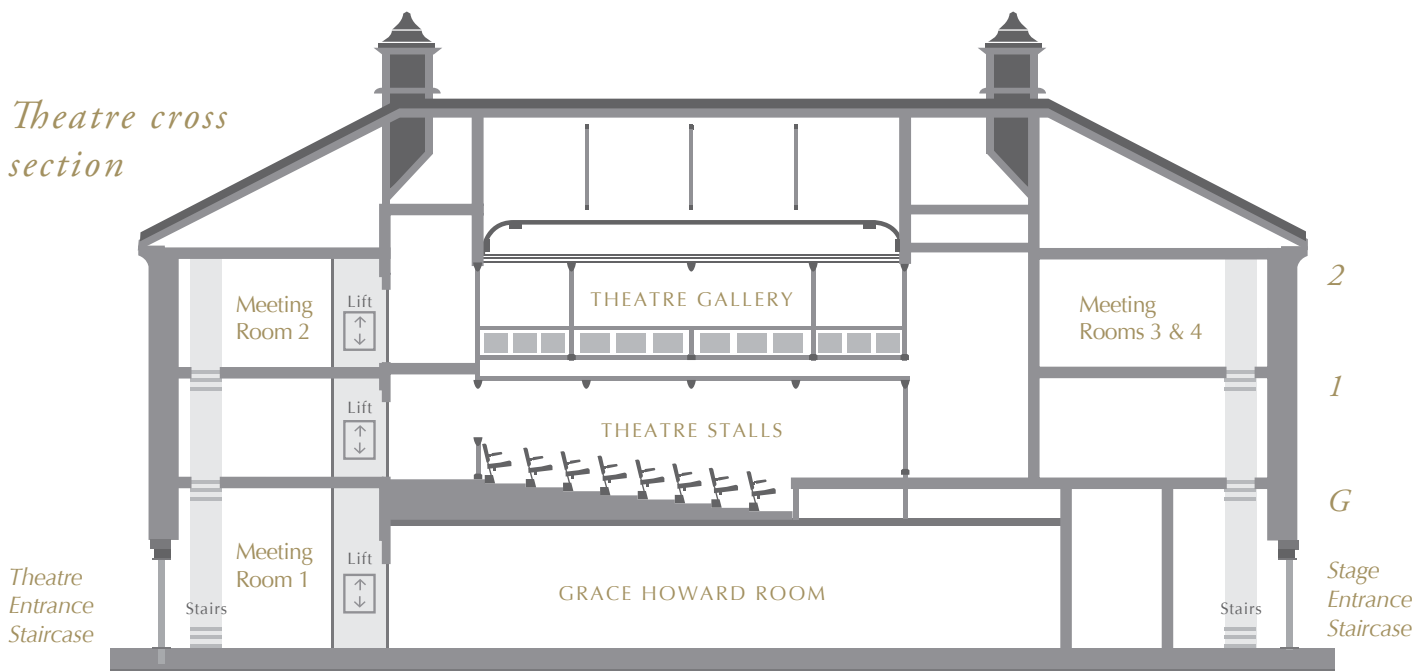

DOWNING COLLEGE  
UNIVERSITY OF CAMBRIDGE

# HOWARD THEATRE MEETING ROOMS 1-4

*Theatre cross section*



Theatre Entrance staircase and lift leads down to fully accessible WCs in basement.

**CAPACITIES** Meeting Rooms 1,2 &3 (Boardroom) **10** Meeting Room 4 (Classroom) **12**

**EQUIPMENT** Room 1 includes 46" display with interactive smart screen. Rooms 2-4 include 46" LCD display with AV connection for a laptop computer. All rooms include AV link to the Howard Theatre system, telephone (VoIP), WiFi (using Lapwing log-in\*) and ethernet connection.

There are four small meeting rooms within the Howard Theatre .

Meeting Rooms 1-3 are set out in boardroom layout for 10 delegates, and Meeting Room 4 is laid out with 12 chairs fitted with writing tablets.

Meeting Rooms 1 or 3 are also ideal locations for a Conference Organisers Office.



\*WiFi is available using a Lapwing log-in code which can be supplied by the Conference Services Office.

CONFERENCE SERVICES

01223 334 860

PLEASE SEE OVERLEAF FOR A MAP SHOWING THE ROOM'S LOCATION IN THE COLLEGE AND ALTERNATIVE ROOM LAYOUTS

conference@dow.cam.ac.uk

# HOWARD THEATRE MEETING ROOMS 1-4

## DOWNING COLLEGE CAMBRIDGE

### ▲ FINDING THE HOWARD THEATRE

All visitors are kindly requested to report to the Porters' Lodge. This can be found on the left hand side as you walk through the main College gates on Regent Street.

### P PARKING

Once inside the main gate, turn right, pass through the barrier and follow car park along to the 'Conference Parking Area'.

### ✓ FIRE ASSEMBLY POINT

In the unlikely event of a fire, please note the Fire Assembly Point for the Howard Theatre is on the Sunken Garden of Howard Court.

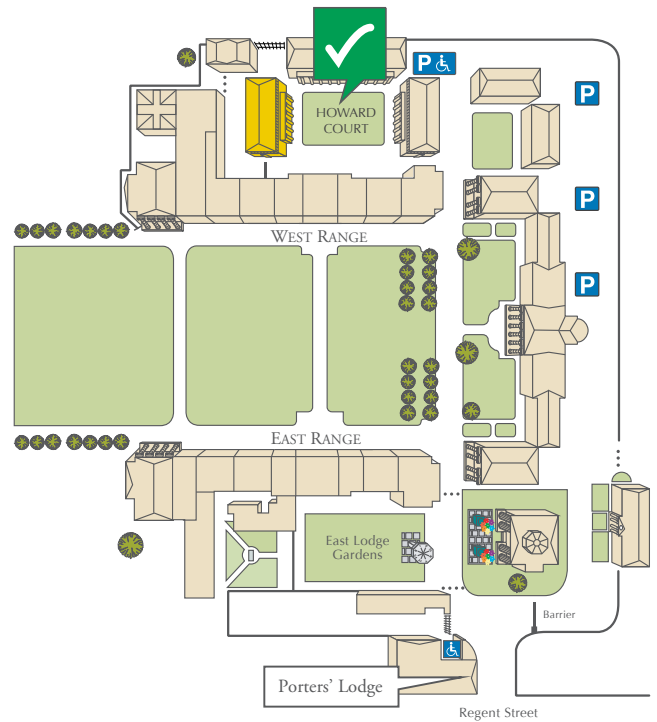

### Ground Floor

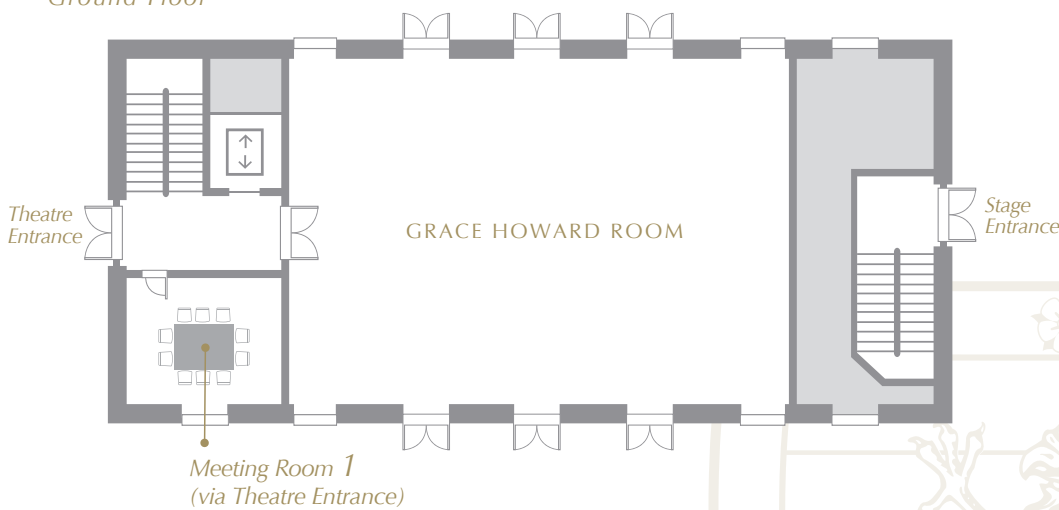

### CAPACITIES

Meeting Room 1 (Boardroom) 10

### DIMENSIONS

Meeting Rooms 1 - 3 (4m x 4.5m) 18 m<sup>2</sup>

Meeting Room 4 (6m x 2.5m) 15 m<sup>2</sup>

### Second Floor

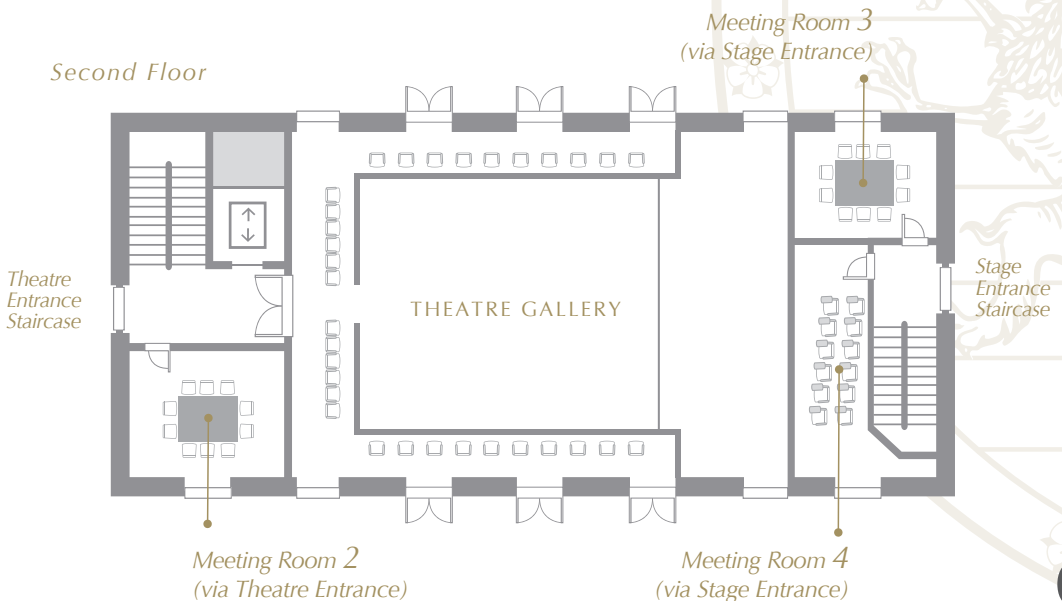

### CAPACITIES

Meeting Rooms 2 & 3 (Boardroom) 10

Meeting Room 4 (Classroom) 12

To discuss further layouts please contact Conference Services

01223 334 860

[www.downing-conferences-cambridge.com](http://www.downing-conferences-cambridge.com) | [conference@dow.cam.ac.uk](mailto:conference@dow.cam.ac.uk)